

Aluminium Single Door Installation

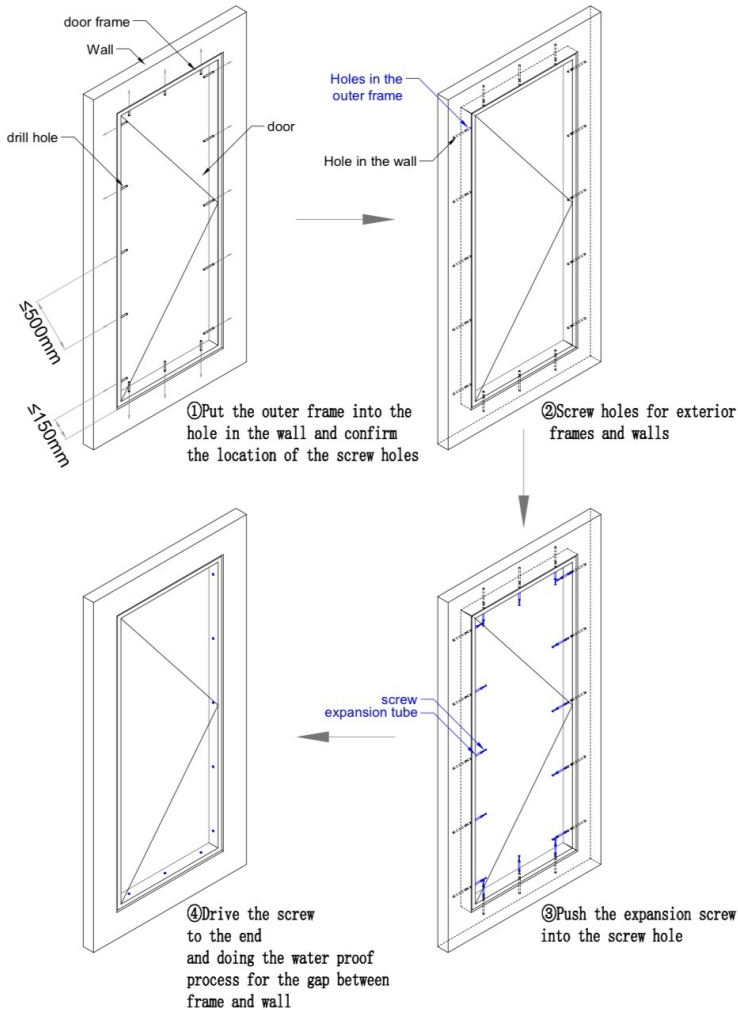

Step 1 – Insert the inside handle with the square shaft into the lock hole of the master door

Step 2 – Put the outside handle into the hole of the square shaft.

Step 3- Screw in the two long screws from the interior handle.

Step 4—Install the lock cylinder, which must be installed from the interior to the exterior. Once installed, test whether it works.

Step 5. The final step is to screw on the positioning screws on the lock cylinder.